

WALDEN WOODS ENTRANCE ISLAND

Key	Botanical Name	Common Name	Size	Quantity
CK	Cornus Kousa	Kousa Dogwood	2-3" B&B	3
AG	Acer glabrum	Spartan Maple	2-2 1/2" B&B	3
KOR	Koel	Knock Out Spirea (Deep Pink)	3 gal	32
PKR	Persicifera 'Kasley Rose'	Fountain Onas	2 gal	22
JB	Hex Helios	Japanese Holly	2 gal	36
IS	Iron Shasta	Upright Japanese Holly	2 gal	25
SG	Spirea 'Goldmound'	Flowering Spirea	2 gal	25
NBW	Nepeta 'Walker's Low'	Catmint	1 gal	60
MMI	Miscanthus 'Morning Light'	Jap. Silver Grass	2 gal	16
H	Hues			12

Hosts to be transplanted from existing bed.

Construction Details

1. Remove all existing trees and plant material. Grind stumps plus the remaining stumps from previously removed trees.
2. Transplant perennials from existing island to large beds to be outlined along Walden Meadow Road. (Hosts: Fig tree, Daylilies). Amend for new planting beds to be designated pending approval of the plan.
3. Remove and preserve existing irrigation system.
4. Install grey cobble ledge perennials to create a separation between the main island and the "seasonal planting beds" at each end of the island.
5. Install new "Drive Safely" sign at north end of island. Sign to read: "Walden Woods" sign at south end of island. Sign to read: "Keep Right Sign".
6. Add spotlights to light both signs during the evening hours.
7. Amend soil with organic material (Compost, new topsoil and fertilizer) as needed per soil test to be conducted by contractor.
8. Install "up lighting" to 5 types in island of and ambient lighting in planting beds.
9. Install plant material per drawings.
10. Reinstall irrigation system.
11. Apply 2" of finely ground dark brown hemlock or cedar bark mulch.
12. Fertilize all plants throughout first year of growing season.

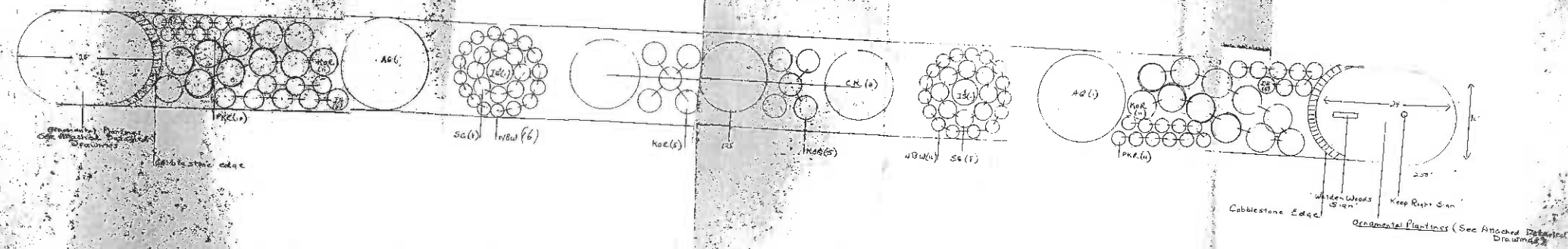

Scale 1/8" = 1'

Design by:
Jill Levine
880-219-8833